

## Device connector, front mounting - SH-8EPS48AAC00S - 1621562

Please be informed that the data shown in this PDF Document is generated from our Online Catalog. Please find the complete data in the user's documentation. Our General Terms of Use for Downloads are valid (<http://phoenixcontact.com/download>)



The figure shows the product version with CAT5 interface

Device connector for front wall, angled rotatable, SPEEDCON locking, M23, Number of positions: 8+4+PE / 3+N+PE, Type of contact: Pin, Crimp connection, Axial O-ring, 4x Ø 3.2, Flange dimensions: 28 mm x 28 mm

### Why buy this product

- Easy connection, thanks to infinitely adjustable cable outlet direction up to 310°
- All housing can be fitted with pin or socket contacts
- A total of eight contacts are available for signal transmission
- Safe use in the field, thanks to high degree of protection
- Consistent EMC protection for reliable connection solutions in the industrial environment



### Key Commercial Data

|                                      |                                |
|--------------------------------------|--------------------------------|
| Packing unit                         | 1 STK                          |
| GTIN                                 |                                |
| GTIN                                 | 4046356937108                  |
| Weight per Piece (excluding packing) | 140.000 g                      |
| Custom tariff number                 | 85366990                       |
| Country of origin                    | Germany                        |
| Note                                 | Made to Order (non-returnable) |

### Technical data

#### Temperature range

|                                 |                   |
|---------------------------------|-------------------|
| Ambient temperature (operation) | -40 °C ... 130 °C |
|---------------------------------|-------------------|

#### Data of the insulating body

|                    |   |
|--------------------|---|
| Note               | Order information: Crimp contacts, 8 x Ø 1 mm, 5 x Ø 2 mm, order separately |
| Coding             | N   |
| Insulator material | Polyamide (PA 6.6)  |

## Device connector, front mounting - SH-8EPS48AAC00S - 1621562

### Technical data

#### Data of the insulating body

|   |                      |
|---|----------------------|
| Insertion/withdrawal cycles mechanical          | 100                  |
| Contact connection method                       | Crimp connection     |
| Type of contacts                                | Pin                  |
| Number of positions                             | 13                   |
| Contact diameter of power contacts              | 2 mm                 |
| Litz wire cross section of power contacts min.  | 0.25 mm <sup>2</sup> |
| Litz wire cross section of power contacts max.  | 4 mm <sup>2</sup>    |
| Nominal current per power contact at 25°C       | 30 A                 |
| Nominal voltage, power contact                  | 630 V AC             |
| Rated surge voltage                             | 6 kV                 |
| Contact diameter of signal contacts             | 1 mm                 |
| Litz wire cross section of signal contacts min. | 0.06 mm <sup>2</sup> |
| Litz wire cross section of signal contacts max. | 1 mm <sup>2</sup>    |
| Nominal current per signal contact at 25°C      | 8 A                  |
| Nominal voltage, signal contact                 | 50 V                 |
| Rated surge voltage                             | 1.5 kV               |
| Overvoltage category                            | III                  |
| Degree of pollution                             | 3                    |

#### Housing data

|  |  |
|--|--|
| Housing material                       | Turned parts: copper zinc alloy (CuZn), die-cast parts: zinc (GD-Zn) |
| Flange dimensions                      | 28 mm x 28 mm  |
| Type of locking                        | SPEEDCON locking   |
| Degree of protection (when plugged in) | IP67   |
|  | IP68   |
| Thread type                            | M23  |

#### Environmental Product Compliance

|            |   |
|------------|---|
| China RoHS | Environmentally Friendly Use Period = 50  |
|            | For details about hazardous substances go to tab "Downloads", Category "Manufacturer's declaration" |

### Drawings

# Device connector, front mounting - SH-8EPS48AAC00S - 1621562

Schematic diagram

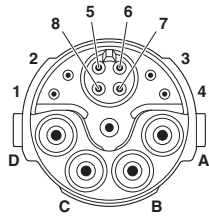

Pin assignment of pin, signal

Dimensional drawing

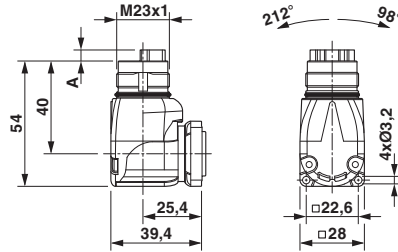

Pin version: dimension A = 4.7 mm, socket version: dimension A = 0 mm

Dimensional drawing

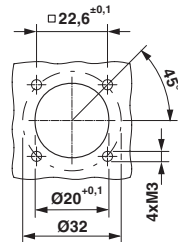

Installation dimensions

## Approvals

Approvals

Approvals

EAC

Ex Approvals

## Approval details

|     |  |         |
|-----|--|---------|
| EAC |  | B.01742 |
|-----|--|---------|