

EPIC® SIGNAL M23 F7

Circular connector for servo cables and encoders

EPIC® M23 coupler with fastening flange

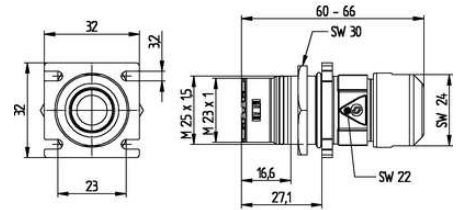
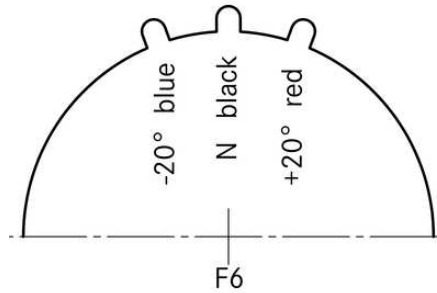

Interference signals



Integrated SKINTOP[®] cable gland



Robust



Optimum strain relief



Good chemical resistance



Wind Energy



Industrial machinery and plant engineering

Benefits

Low-resistance screen contact, optimum EMC protection
Use of high-quality materials for increased durability

Application range

Plant construction
Servo drives and servo assemblies
Measurement, control and regulation technology

Last Update (09.05.2017)

©2017 Lapp Group - Technical changes reserved

Product Management www.lappkabel.de

You can find the current technical data in the corresponding data sheet.

PN 0456 / 02_03.16

EPIC® SIGNAL M23 F7**Technical Data**

Classification:	ETIM 5.0 Class-ID: EC000437 ETIM 5.0 Class-Description: Housing for industrial connectors
Material:	Housing: Nickel-plated zinc die-casting Seal: FPM
Protection rating:	IP68 (10h/1m)
VDE-tested:	Certified production control: VDE reg. no. C24 (according to EN 61984, SELV according to DIN VDE 0100-410 has to be guaranteed) UL file number: E249137
Temperature range:	-25°C to +125°C

Note

Photographs are not to scale and do not represent detailed images of the respective products.
Prices are net prices without VAT and surcharges. Sale to business customers only.

**EPIC® SIGNAL M23 F7**

Article number	Article	Coding	Cable clamping range	Fastening type
Type M23 F7 flush-type plug, front/rear wall mounting				
44420009	M23 F7	black (N)	7 - 10	Ø 3.2 mm (4x), M25 x 1.5 (with nut)
44420010	M23 F7	black (N)	7 - 10	Ø 3.2 mm (4x), M25 x 1.5 (with nut)
44420011	M23 F7	black (N)	9.5 - 13.5	Ø 3.2 mm (4x), M25 x 1.5 (with nut)
44420012	M23 F7	black (N)	9.5 - 13.5	Ø 3.2 mm (4x), M25 x 1.5 (with nut)
44420001	M23 F7	red (+20°)	7 - 10	Ø 3.2 mm (4x), M25 x 1.5 (with nut)
44420002	M23 F7	red (+20°)	7 - 10	Ø 3.2 mm (4x), M25 x 1.5 (with nut)
44420003	M23 F7	red (+20°)	9.5 - 13.5	Ø 3.2 mm (4x), M25 x 1.5 (with nut)
44420004	M23 F7	red (+20°)	9.5 - 13.5	Ø 3.2 mm (4x), M25 x 1.5 (with nut)
44420005	M23 F7	blue (-20°)	7 - 10	Ø 3.2 mm (4x), M25 x 1.5 (with nut)
44420006	M23 F7	blue (-20°)	7 - 10	Ø 3.2 mm (4x), M25 x 1.5 (with nut)
44420007	M23 F7	blue (-20°)	9.5 - 13.5	Ø 3.2 mm (4x), M25 x 1.5 (with nut)
44420008	M23 F7	blue (-20°)	9.5 - 13.5	Ø 3.2 mm (4x), M25 x 1.5 (with nut)

Last Update (09.05.2017)

©2017 Lapp Group - Technical changes reserved

Product Management www.lappkabel.de

You can find the current technical data in the corresponding data sheet.

PN 0456 / 02_03_16