

EPIC® POWER LS1.5 F6

Circular connector for servo drives and power supply.

EPIC® LS1.5 coupler for male contacts for cable extensions

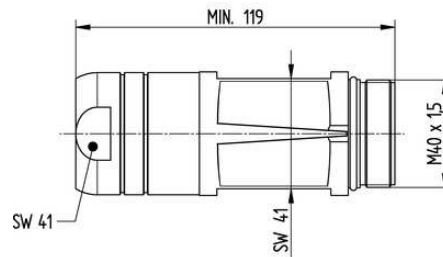

Waterproof



Interference signals



Robust



Optimum strain relief



Mechanical resistance



Wide clamping range



Industrial machinery and plant engineering

Benefits

more power for servo motors

Vibration-proof robust design

EMC version for cables with large cross-sections

Application range

Plant construction

Servo drives and servo assemblies

Last Update (09.05.2017)

©2017 Lapp Group - Technical changes reserved

Product Management www.lappkabel.de

You can find the current technical data in the corresponding data sheet.

PN 0456 / 02_03.16

EPIC® POWER LS1.5 F6

Technical Data

Classification:	ETIM 5.0 Class-ID: EC002635 ETIM 5.0 Class-Description: Circular connector (industrial connector)
Rated voltage (V):	630 V (3.6mm contacts) 250 V (2mm contacts)
Rated impulse voltage:	6 kV (3.6 mm contacts) 4 kV (2 mm contacts)
Rated current in A:	70 A (3.6 mm contacts) at 25 °C 30 A (2mm contacts) at 25 °C
Pollution degree:	3
Contacts:	Gold-plated brass
Number of contacts:	3+PE+2(3.6mm/2mm) 3+PE+4(3.6mm/2mm)
Cable connection:	Crimp termination: 0.75 – 10 mm ² (3.6mm contacts) Crimp termination: 0.14 - 4.0 mm ² (2mm contacts)
Material:	Housing: Nickel-plated zinc die-cast, nickel-plated brass Insulating body: PA Seal: FPM
Protection rating:	IP 67
Plug cycles:	50
Temperature range:	-20 °C až +125 °C

Note

Photographs are not to scale and do not represent detailed images of the respective products.
Prices are net prices without VAT and surcharges. Sale to business customers only.

**EPIC® POWER LS1.5 F6**

Article number	Article description	Clamping range in mm	Pin configuration
Type LS1.5 F6 for male contacts			
44429300	EPIC® POWER LS1.5 F6	9 - 14	3+PE+2
44429301	EPIC® POWER LS1.5 F6	14 - 20.5	3+PE+2
44429302	EPIC® POWER LS1.5 F6	20.5 - 26.5	3+PE+2
44429303	EPIC® POWER LS1.5 F6	9 - 14	3+PE+4
44429304	EPIC® POWER LS1.5 F6	14 - 20.5	3+PE+4
44429305	EPIC® POWER LS1.5 F6	20.5 - 26.5	3+PE+4

Last Update (09.05.2017)

©2017 Lapp Group - Technical changes reserved

Product Management www.lappkabel.deYou can find the current technical data in the corresponding data sheet.
PN 0456 / 02_03_16