



Product information
RKMF 4/0.5 M - RKMF 4/0,5 M
11292

Name		RKMF 4/0.5 M
		
		Receptacle connector, M8 female connector for front mounting, assembled stranded wire, solder contacts potted with epoxy, chassis side thread M8 x 0.5 (panel nut RSKF 8), 4 poles, 0.5 meters
Delivery informations		
Availability		available
Product description		
Type		RKMF 4/0,5 M
Order No.		11292
Description		Receptacle connector, M8 female connector for front mounting, assembled stranded wire, solder contacts potted with epoxy, chassis side thread M8 x 0.5 (panel nut RSKF 8), 4 poles, 0.5 meters
Note		The application of these products in harsh environments should always be checked before use.
Number of contacts		4
Color of housing		chromium
Product characteristics		Oil resistance
Classification		
Belden brand		Lumberg-Automation
Mechanical data		
Type of plug-in contact		Female connector
Design of housing		straight
Thread		M8
Design of electrical connection		stranded wire
LED display present		✗
Environmental conditions		
Environmental temperature		-25 °C ... 80 °C
Degree of protection (IP), mounted		IP67
Pollution degree		3
Materials		
Housing material / Molded body		CuZn, nickel-plated
Contact bearer material		TPU, self-extinguishing
Contact material		CuZn
Contact material - Surface refinement		pre-nickeled and 0.8 microns gold-plated
Sealing material		FKM
Electrical data		
Contact resistance		≤ 5 mΩ
Rated current I _n		4 A at 40°C
Nominal voltage		60 V
Rated voltage		63 V
Test voltage		1.5 kV eff./60 s
Insulation resistance		> 1 GΩ
Approvals		
Approvals		UL



Picture
Drawing

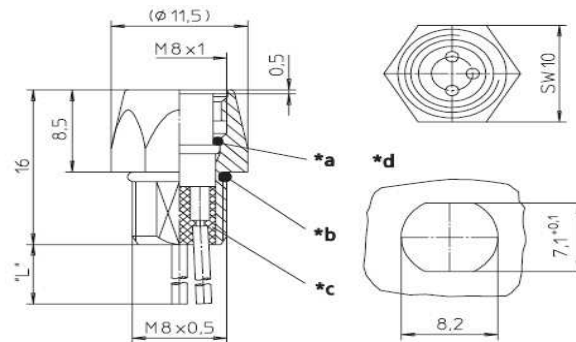

- *a O-Ring
O-ring
- *b O-Ring lose beige stellt
O-ring enclosed separately
- *c Leiteranschlussbereich vergossen
solder contacts potted with epoxy
- *d Einbauöffnung
cut out
- "L" 0,5 m

**4-polig
4 poles**



- 1 = braun / brown
- 2 = weiß / white
- 3 = blau / blue
- 4 = schwarz / black