

3.50mm(.138") HEADER 90°

MATERIAL

Insulator: Nylon UL 94V-0
 Color: Black
 Contact: Brass
 Plating: Tin over Nickel

SPECIFICATIONS

Current rating: 14A AC/DC
 Voltage rating: 400V AC/DC

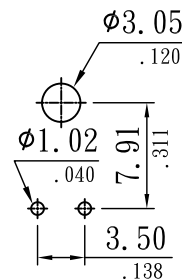
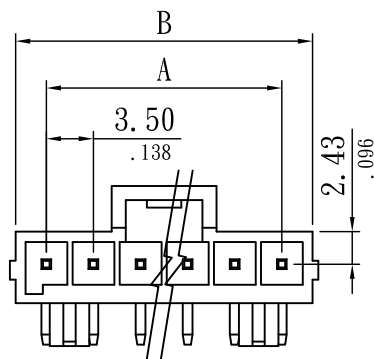

PCB LAYOUT
2 PIN

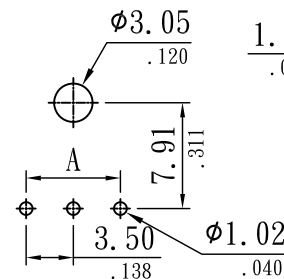

PCB LAYOUT
3 PIN

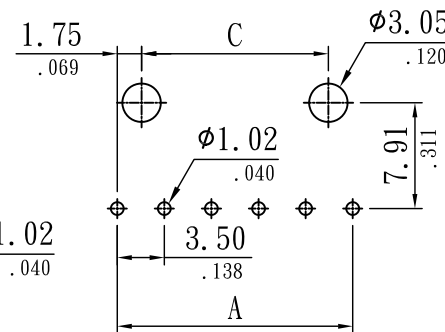

PCB LAYOUT
4~12 PIN

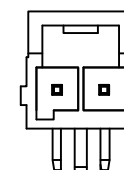
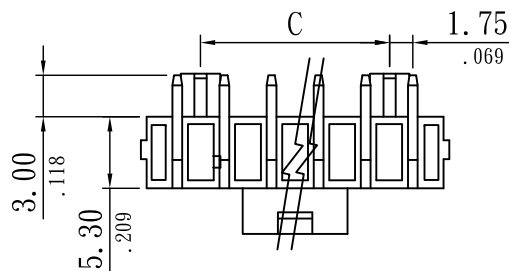
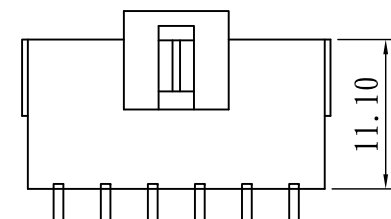
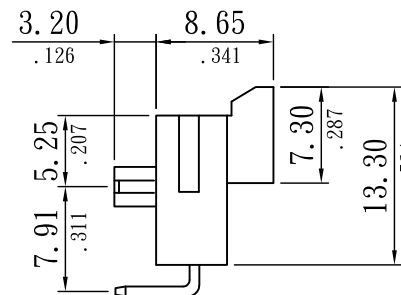
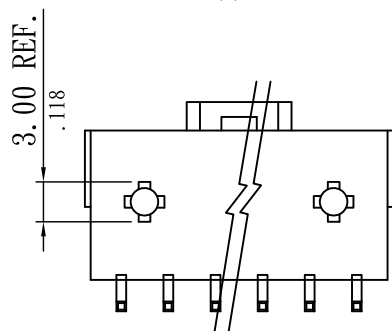

2 PIN

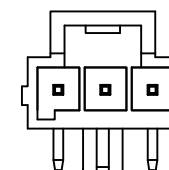

3 PIN

Dimensional Information

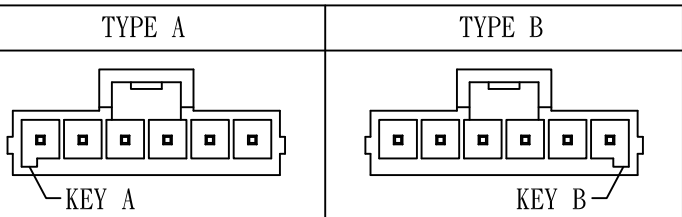

Circuits	DIM. A		DIM. B		DIM. C		Circuits	DIM. A		DIM. B		DIM. C	
	mm	in	mm	in	mm	in		mm	in	mm	in	mm	in
2	3.50	0.138	8.15	0.321	-	-	8	24.50	0.965	29.15	1.148	21.00	0.827
3	7.00	0.276	11.65	0.459	-	-	9	28.00	1.102	32.65	1.285	24.50	0.965
4	10.50	0.413	15.15	0.596	7.00	0.276	10	31.50	1.240	36.15	1.423	28.00	1.102
5	14.00	0.551	18.65	0.734	10.50	0.413	11	35.00	1.378	39.65	1.561	31.50	1.240
6	17.50	0.689	22.15	0.872	14.00	0.551	12	38.50	1.516	43.15	1.699	35.00	1.378
7	21.00	0.827	25.65	1.010	17.50	0.689							

M030	NAME	DATE	SCALE: NTS	REV NO	DATE	DESCRIPTION	BY	CHECKED	TOLERANCE UNLESS NOTED	
DRAWN	RALF	2022. 11. 16	UNIT: mm(in.)	A					LINEAR±	.0 ±0.30(.012)
CHECKED			CAD NO	B						.00 ±0.20(.008)
APPROVED			R3541-xxTR-x	C						.000±0.10(.004)
									PROJECTION:	