

# Safety Cut-out Switches 16A 250Vac



**C0320AA**  
16.1A 250Vac



**C0320BB**  
16(4)A 250Vac 1/2hp



μ contact gap

These safety switches are assembled with snap-action switches shown on pages 50 and 51

Technical data, alternative ratings and approvals are listed on the above pages



*Safety requirements for Portable Heaters can be met by the fitting of a safety cut-out switch  
The heater will then turn off if overturned*

## C0320AA - - -

TERMINAL FUNCTION ACTUATOR MOUNTING

ORDER CODE	TERMINAL	FUNCTION	ACTUATOR	MOUNTING
<b>C0320AA</b>	 6.3 x 0.8 12.5	 ON - OFF (momentary OFF)		 2 holes Ø3.2 10.3 22.2
<b>C0320BB</b>	 6.3 x 0.8 12.5	 ON - OFF (momentary OFF)		 Ø3.8 8.5 1.5 9.3 9.0 9.0 3 holes Ø3.0

**Dimensions** (mm) (for assemblies fitted with 340 & 390 series switches)

### C0320AA

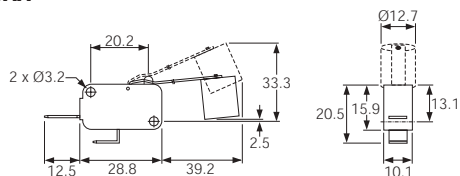

### C0320BB

